

TILLAMOOK COUNTY SURVEYORS OFFICE

1/4 corner common to sections 16 & 21 T.1N.,R.9W.,W.M.

S 16  
1/4---+---  
S 21  
1972  
RS 401

I set a 10" concrete cylinder around the found O.S.B.F. 1 1/2" iron pipe with 3" bronze disk set in 1972 by proportion by Richard A. Morris L. S. 401; (See Tillamook County Surveyors Map #B-663).

-----  
History of found monument

I found this corner to be as described on the above said rewitness, and its' accessory set at that time to now be as listed below:

\*16" hemlock S.17\*E. 82.5'; (Now 25" hemlock, scribing visible on partially healed, rotten face).

12" alder N.20\*W. 19.7'; (Now 16" alder N.20\*W. 20.8' scribing visible with O.S.B.F. tag attached).

YMLP on alder S.14\*W. 88.0' on easterly edge of road; (now a 16" alder S.14\*W. 88.8').

-----  
New Accessories

\*72" light hat section post North 1.5'.

\*indicates yellow Tillamook County location poster attached.

-----  
Monument location

This corner is located approximately 105' Northeasterly of the Kilchis River Forest Road in a grove of alders.

-----  
In the presence of Dan McNutt & Al Dvorak

July 1990

Title:

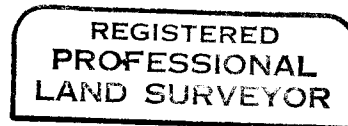
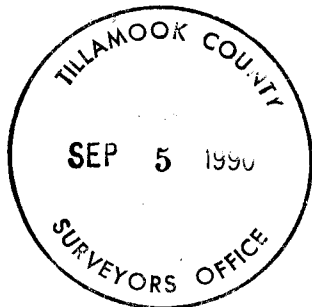

*Allan E. Duncan, C.S.*

